

Weller®



CN 原装使用说明

® **海洋儀器**

致力于电子测试、维护领域!

WTSF 80
WTSF 120
WXSF 120

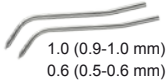
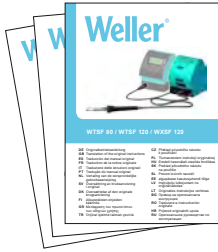

0.8 (0.7-0.8 mm)



WTSF 80

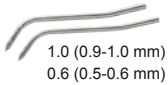

0.8 (0.7-0.8 mm)



WTSF 120

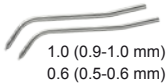

0.8 (0.7-0.8 mm)



WXSF 120



CN 配件

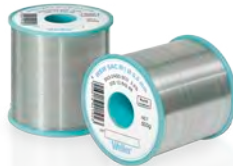

| Ø | WSW SAC M1 | WSW SAC L0 | WSW SC L0 | WSW SC M1 |
|--------|----------------|----------------|----------------|----------------|
| | Sn3.0Ag0.5Cu | Sn3.0Ag0.5Cu | Sn0.7Cu | Sn0.7Cu |
| 0,5 mm | T005 13 864 99 | T005 13 870 99 | T005 13 880 99 | T005 13 876 99 |
| 0,8 mm | T005 13 863 99 | T005 13 869 99 | T005 13 879 99 | T005 13 875 99 |
| 1,0 mm | T005 13 862 99 | T005 13 868 99 | T005 13 878 99 | T005 13 874 99 |

WTSF 80

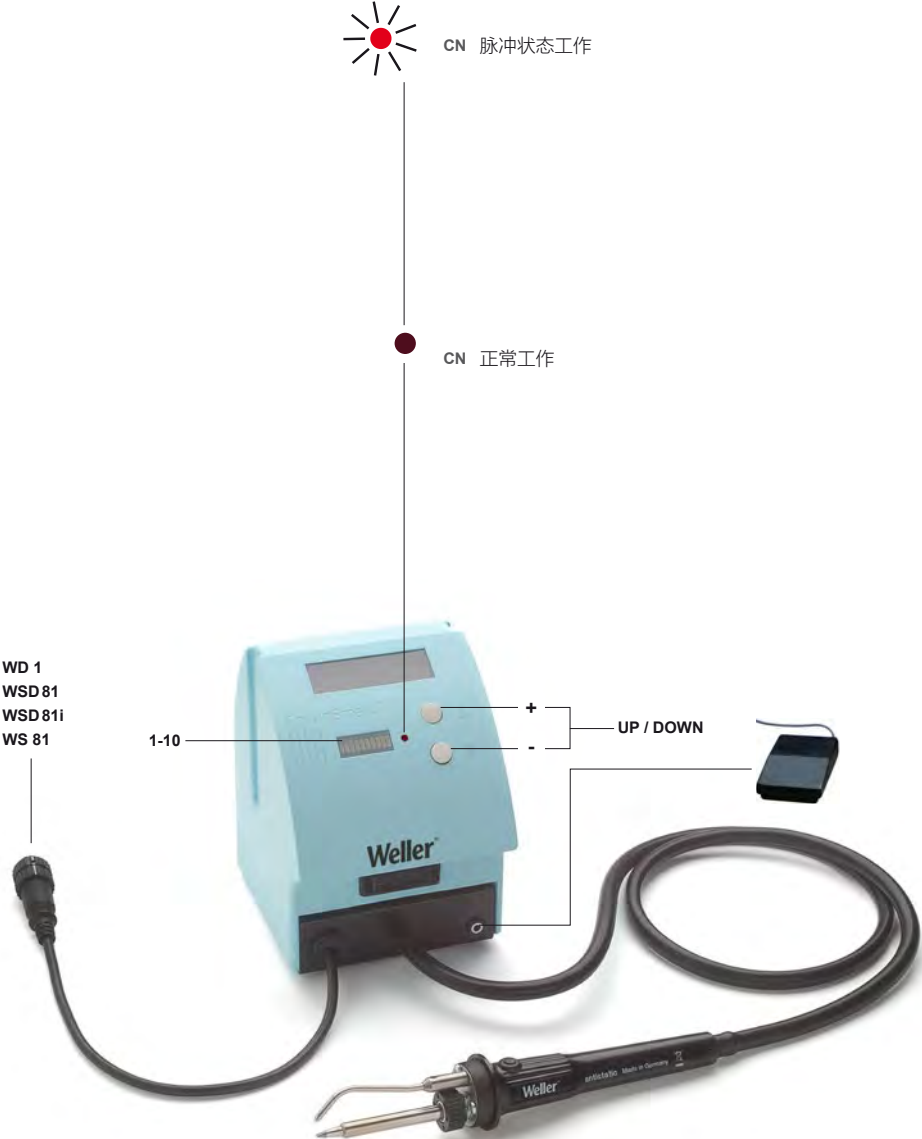

WTSF 120 / WXSF 120



CN 脉冲状态工作



CN 正常工作



WD 1M, WSD 121,
WR 2, WR 3M

WTSF 120

WX1, WX2, WXD 2,
WXS1, WXS2, WXS3

北京海清兴业科技股份有限公司 (证券代码: 839145) 电话: 010-62176775

www.hyxyyq.com

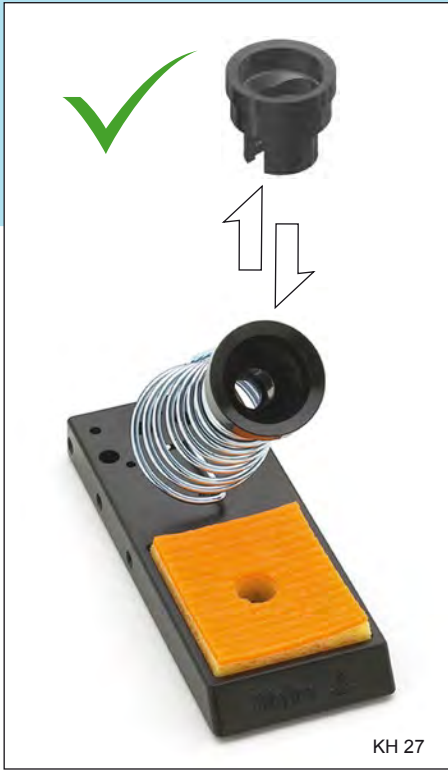

CN 焊接工具不用时，请放在安全托架上。

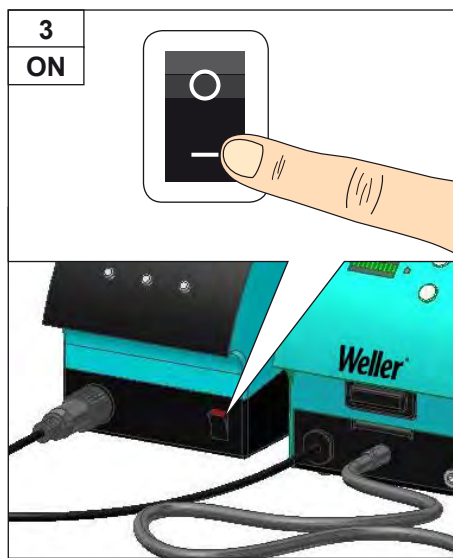
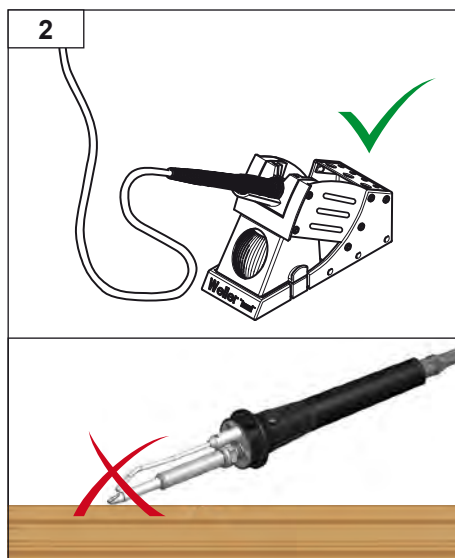



CN 正常工作



CN 脉冲状态工作

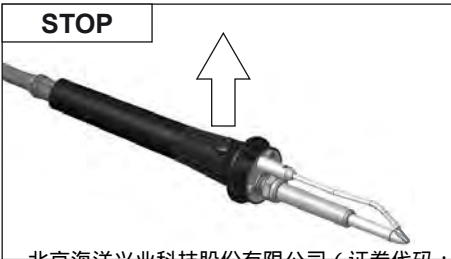
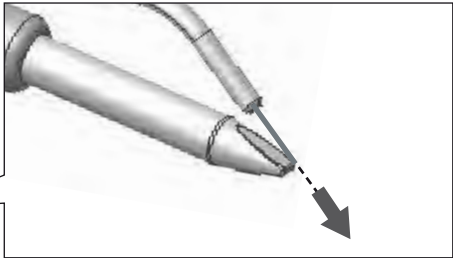
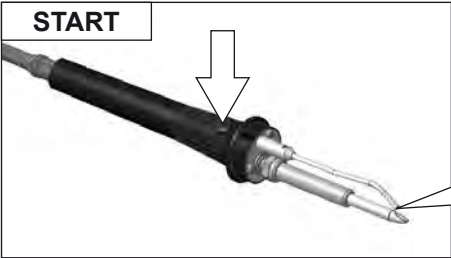
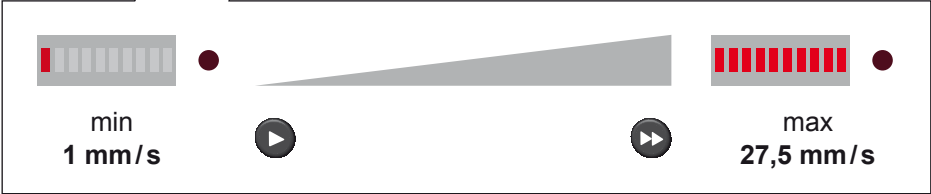
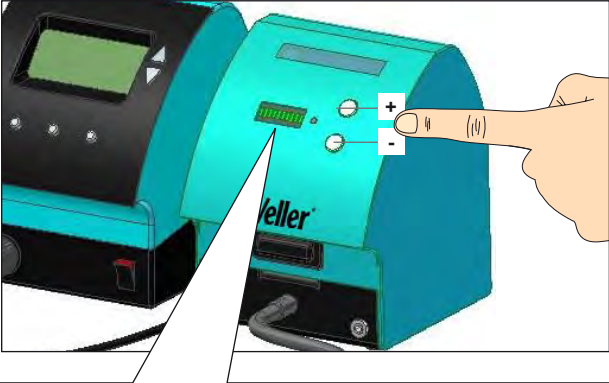

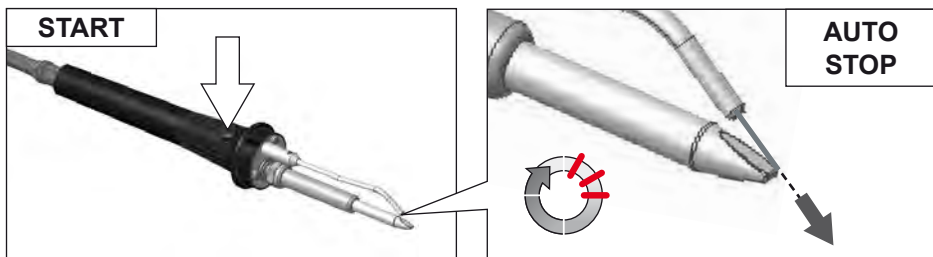
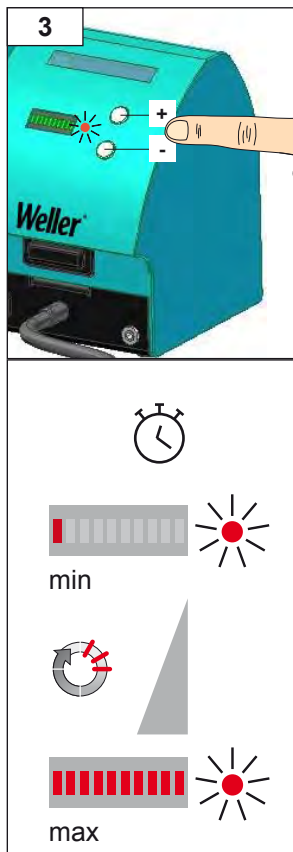
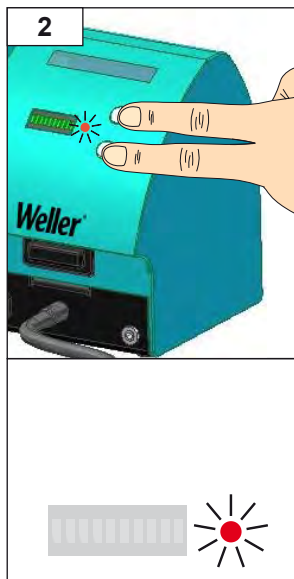
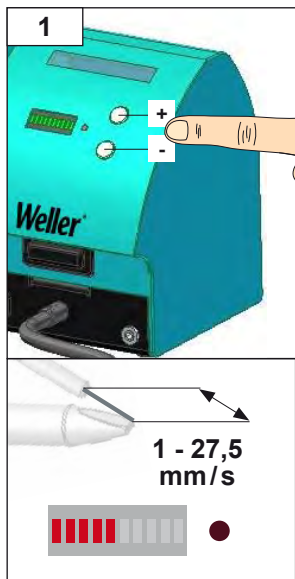

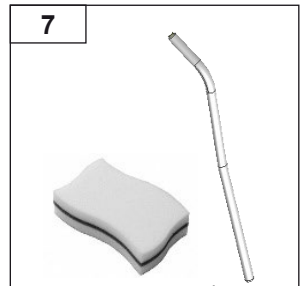
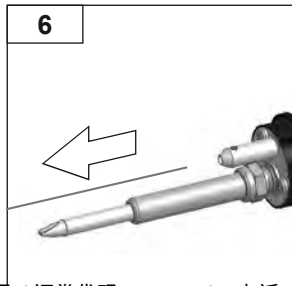
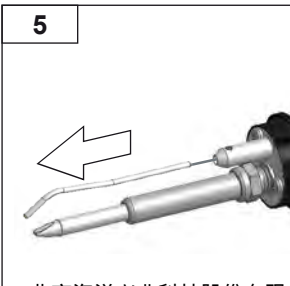
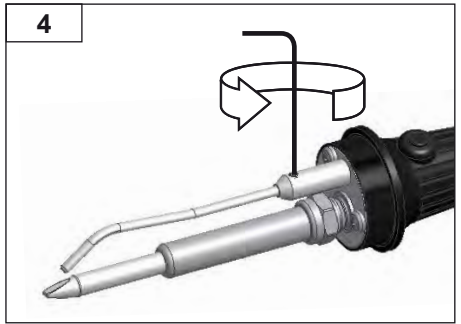
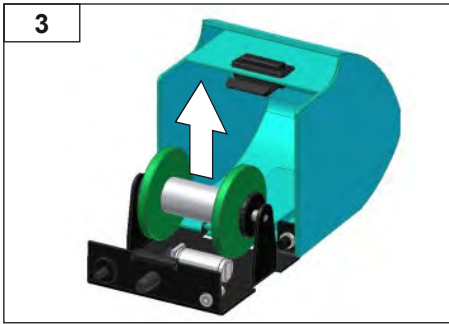
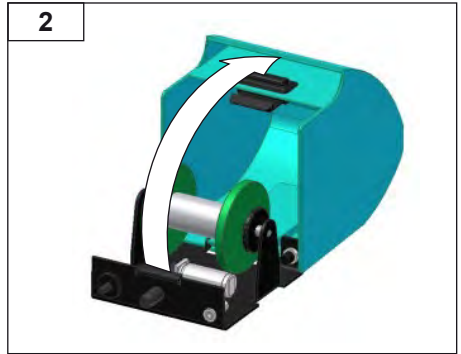
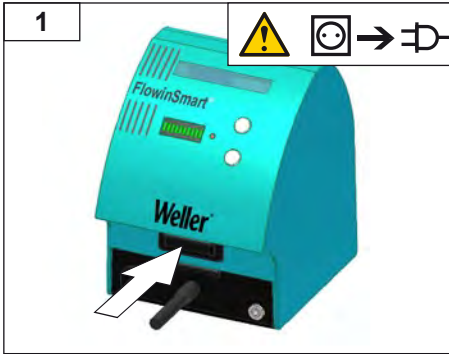

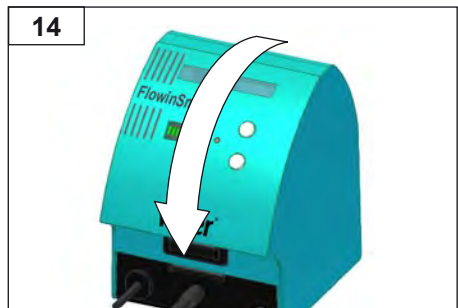
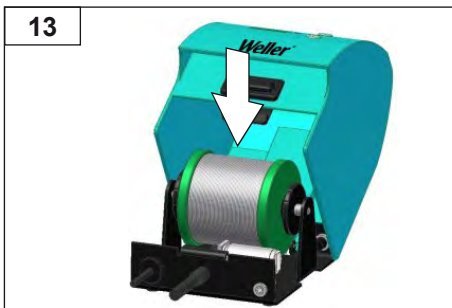
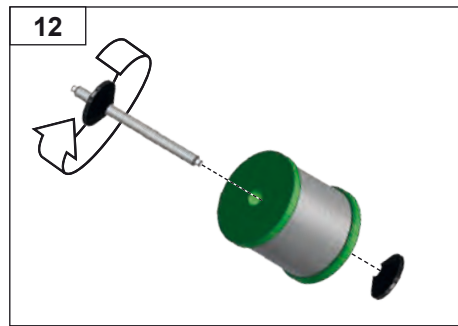
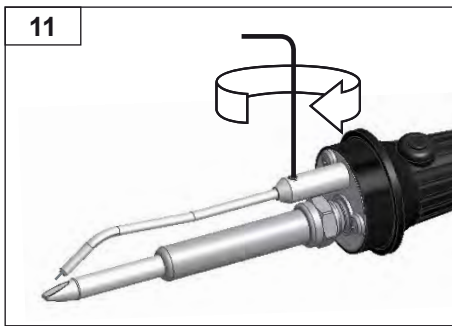
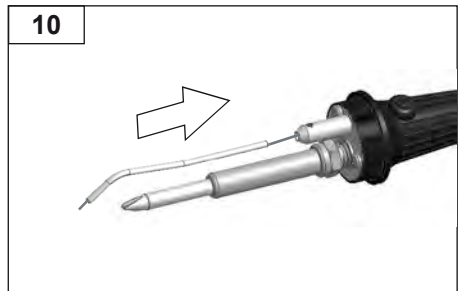
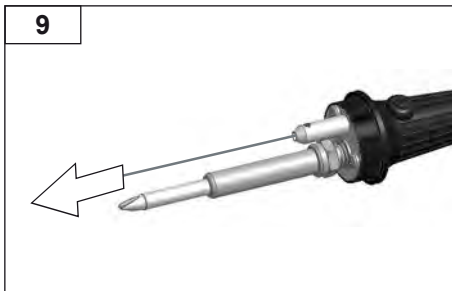
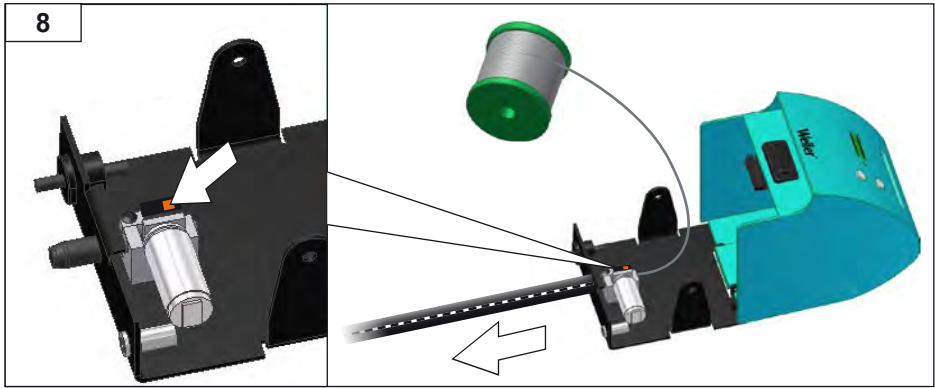

WTSF 80

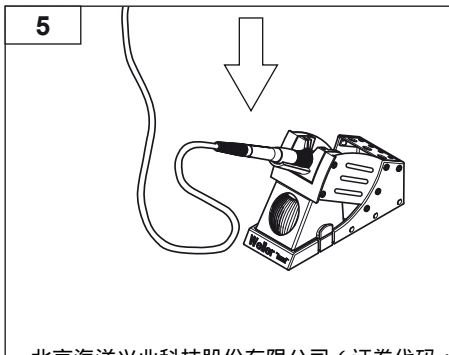
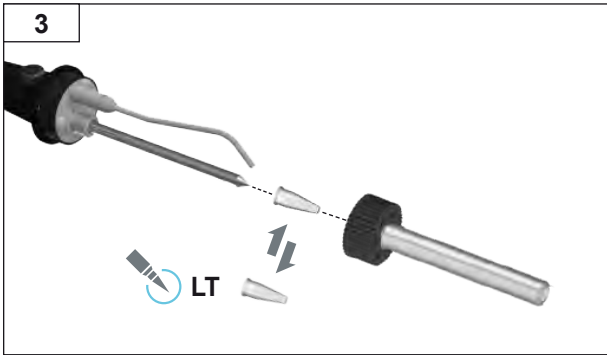
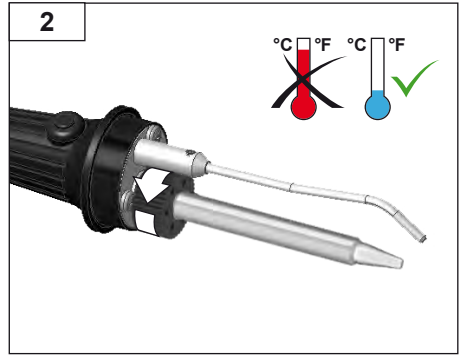
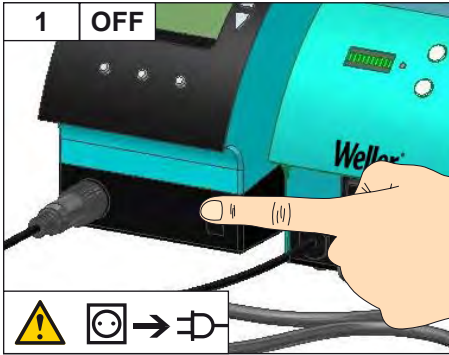

WTSF 120 / WXSF 120

