

Weller®



CN 原装使用说明

WTQB 1000

 海洋儀器

致力于电子测试、维护领域!

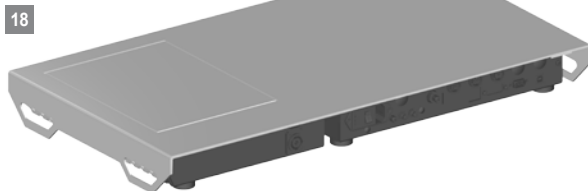
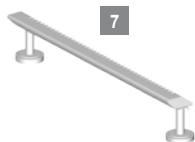
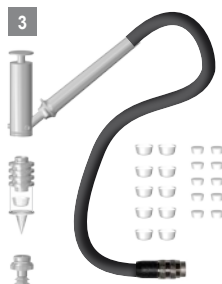
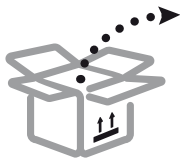

1



WINDOWS 7 & 10

4 GB RAM
1280x1024



WTQB 1000 Control



1



2

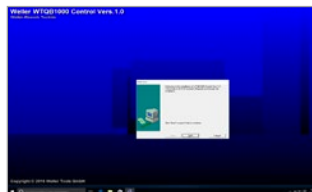
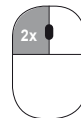
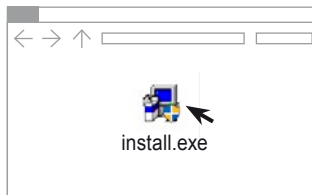

2

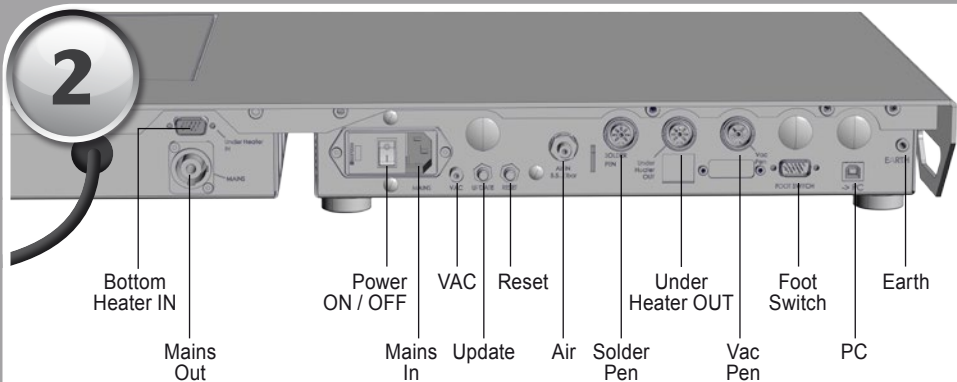

3

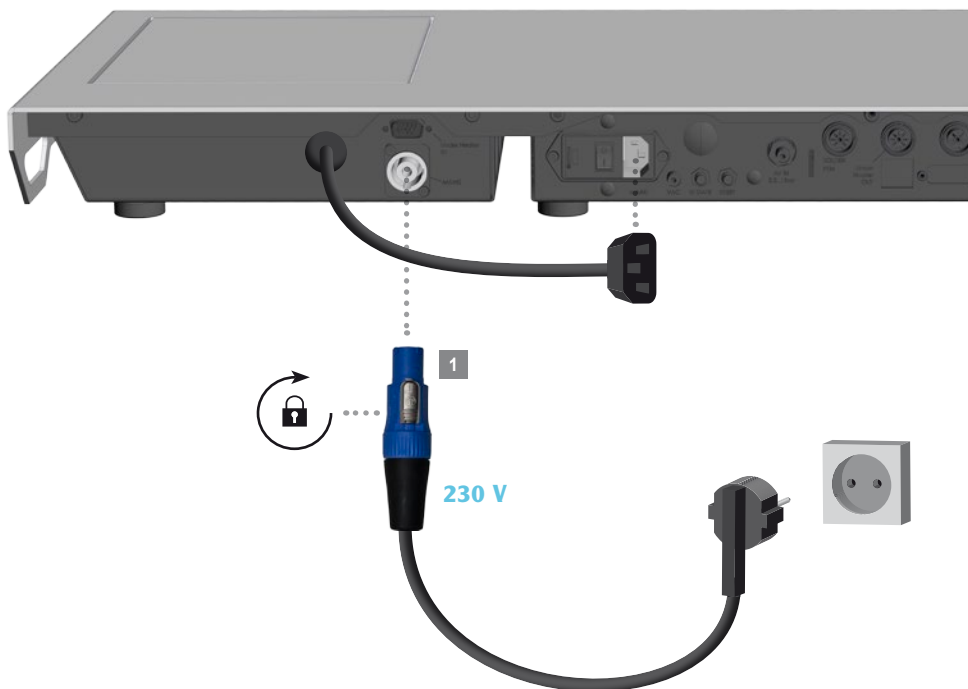

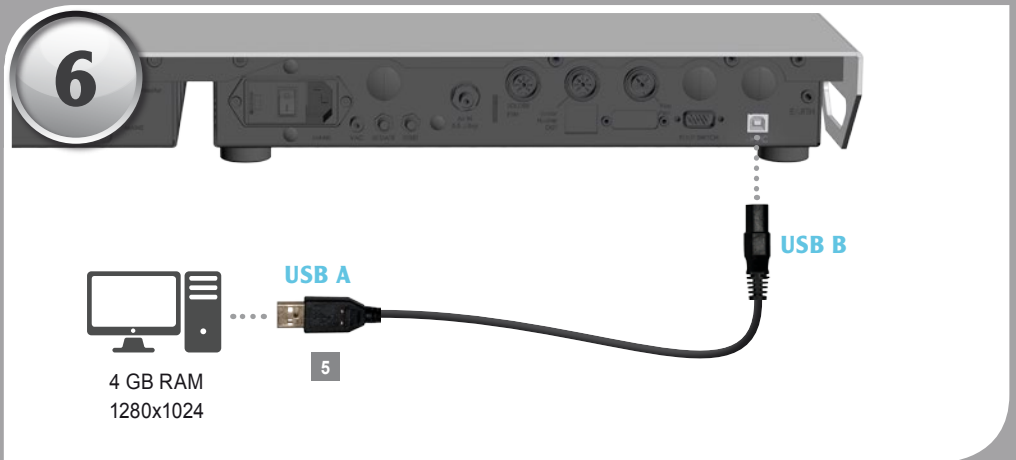
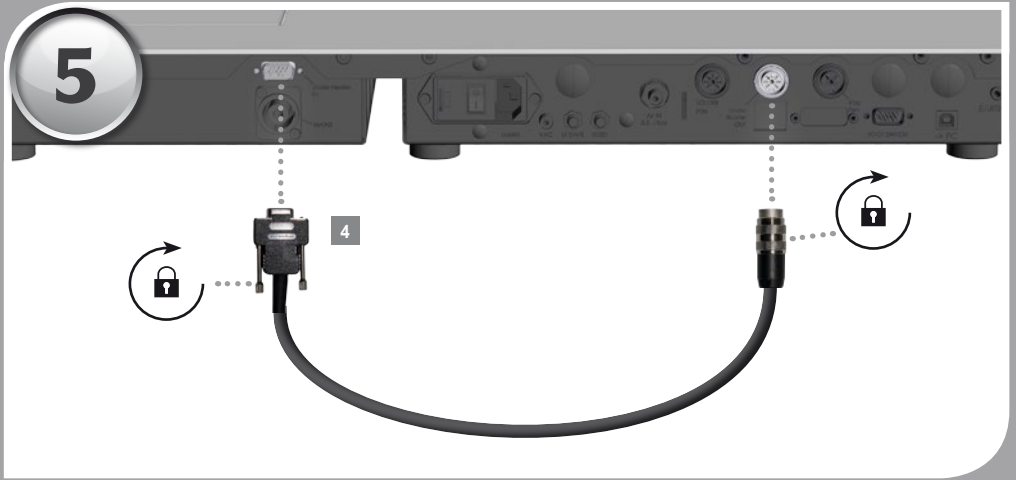
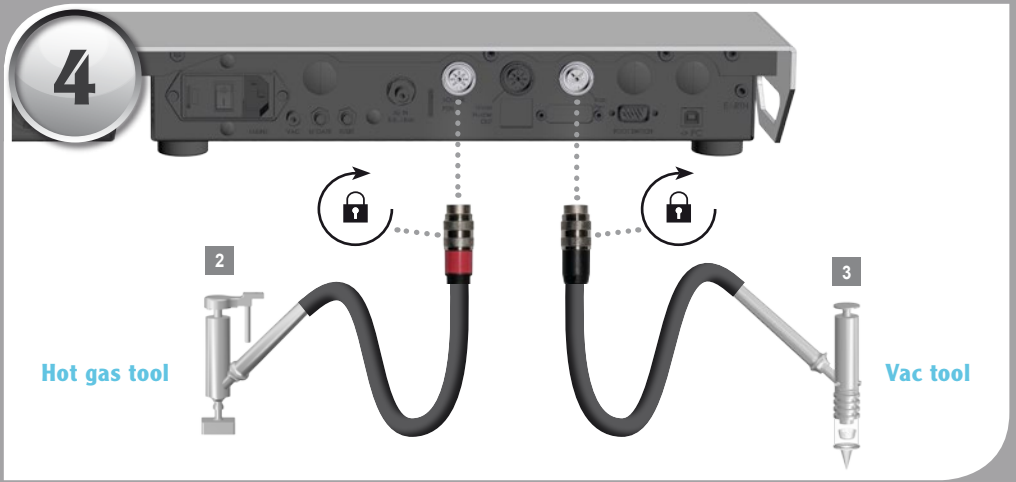

7



6



5,5 bar
(5 - 8 bar)

8

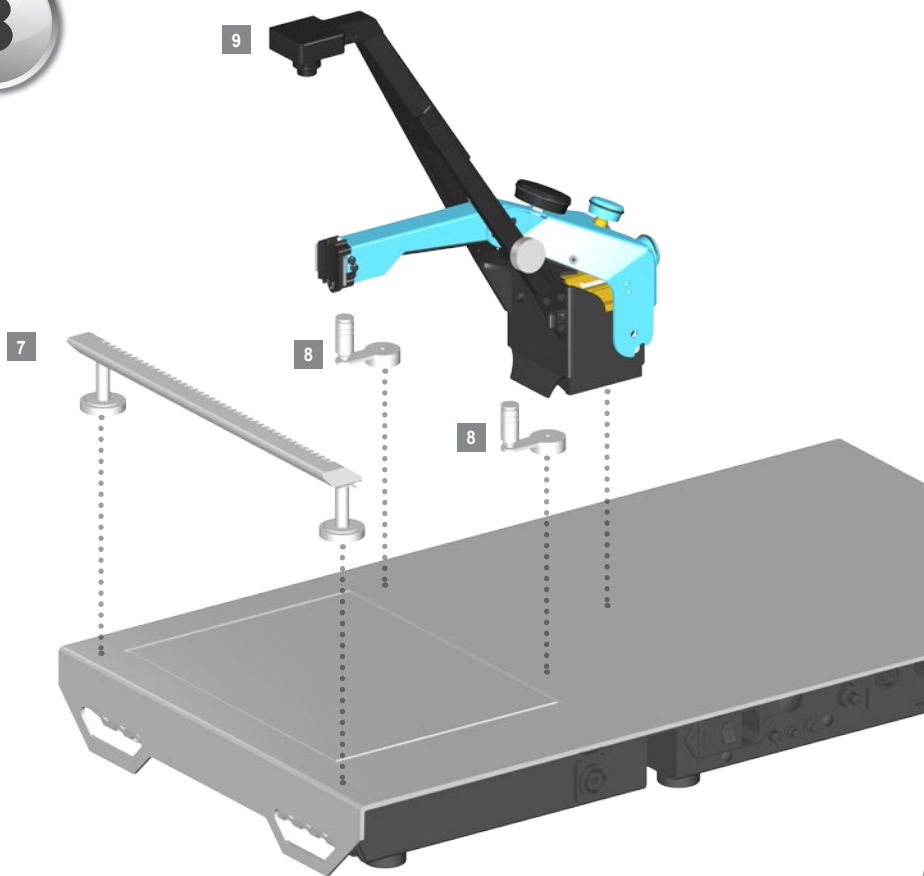

9

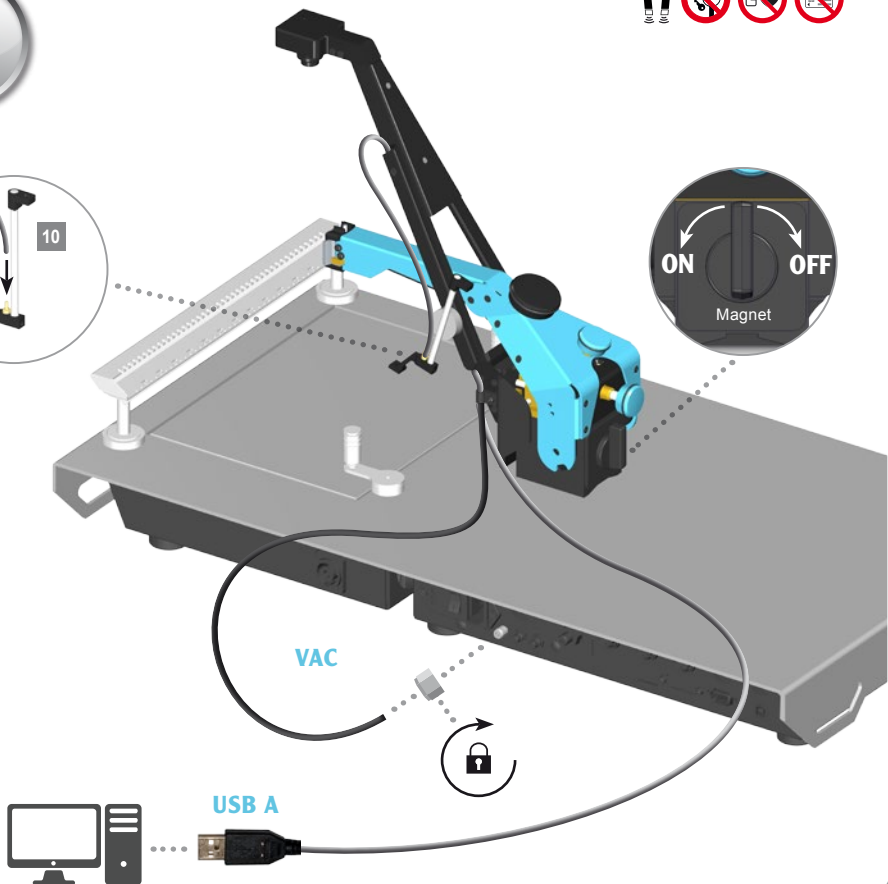
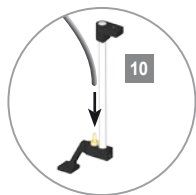

10

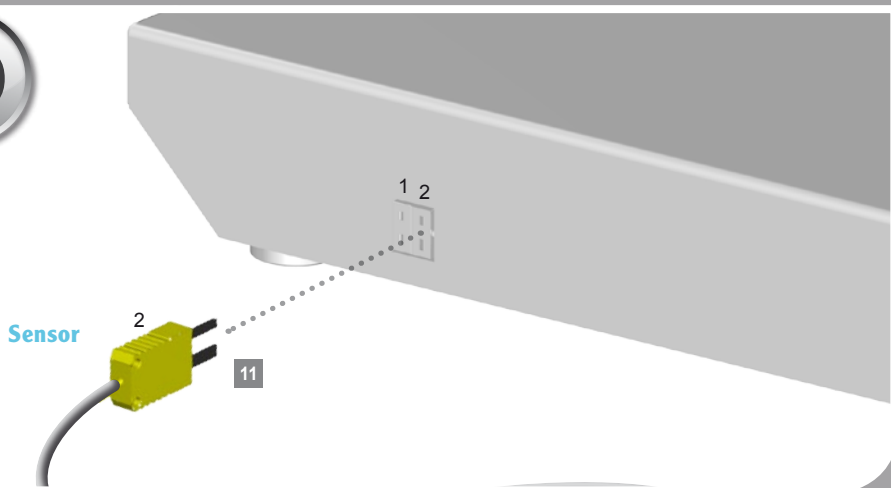

11

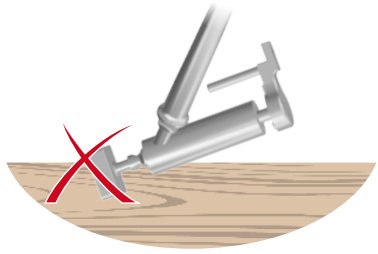
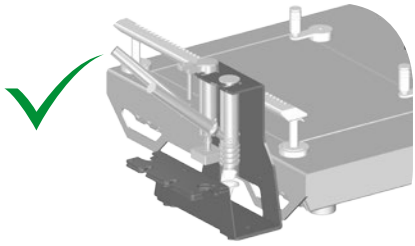
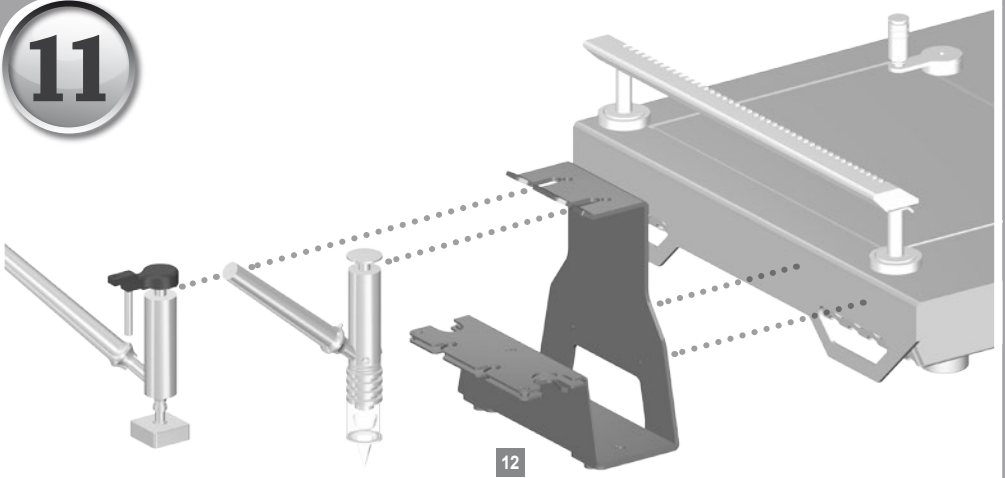

Hot gas tool

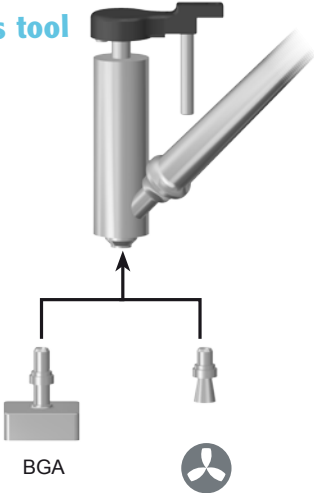

Vac tool

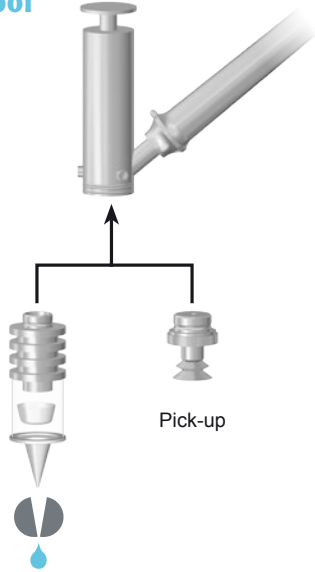

11

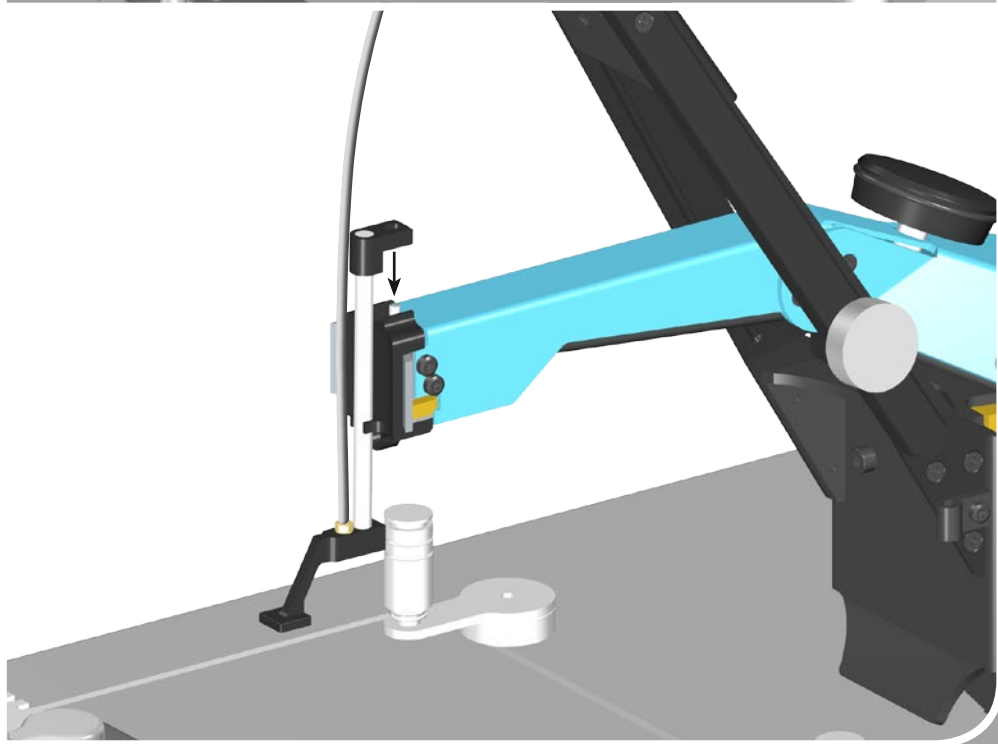
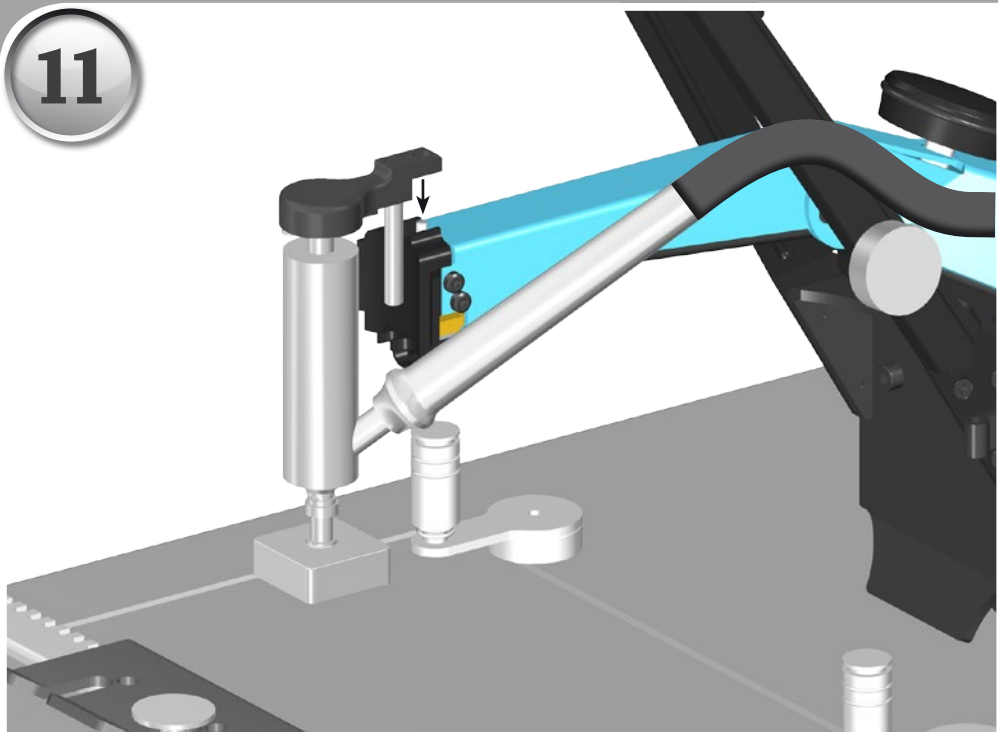

12

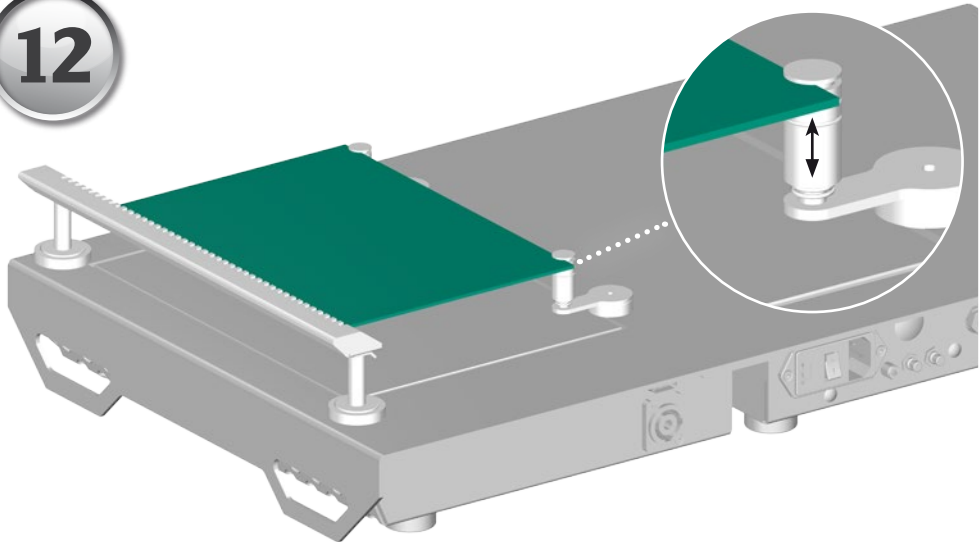

13

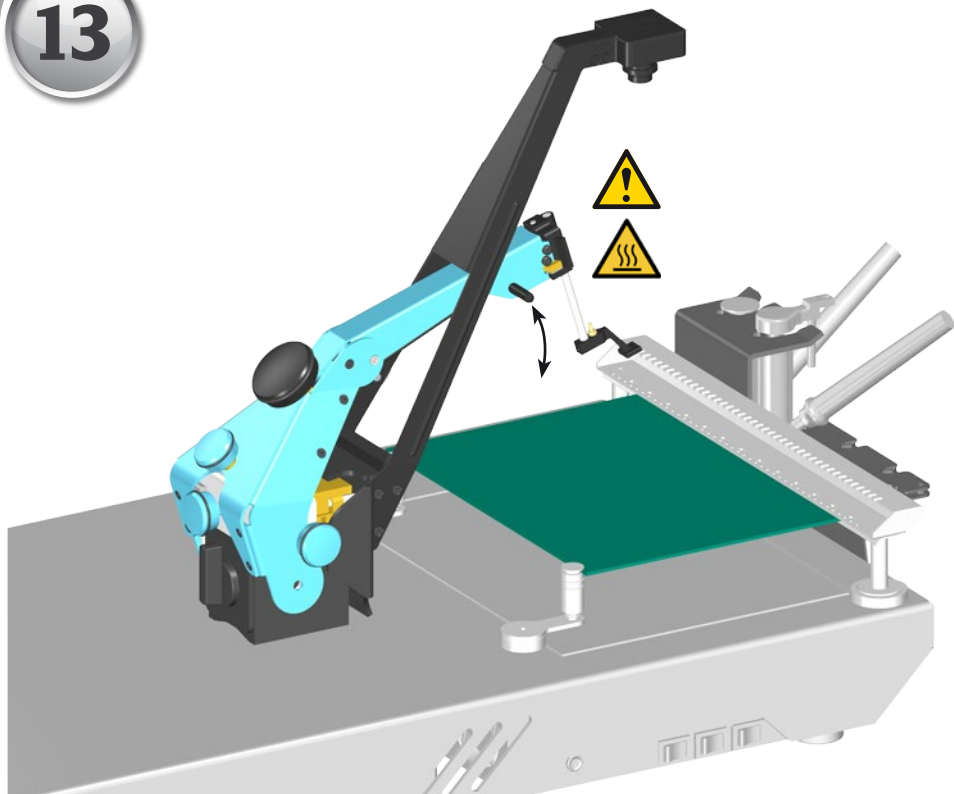

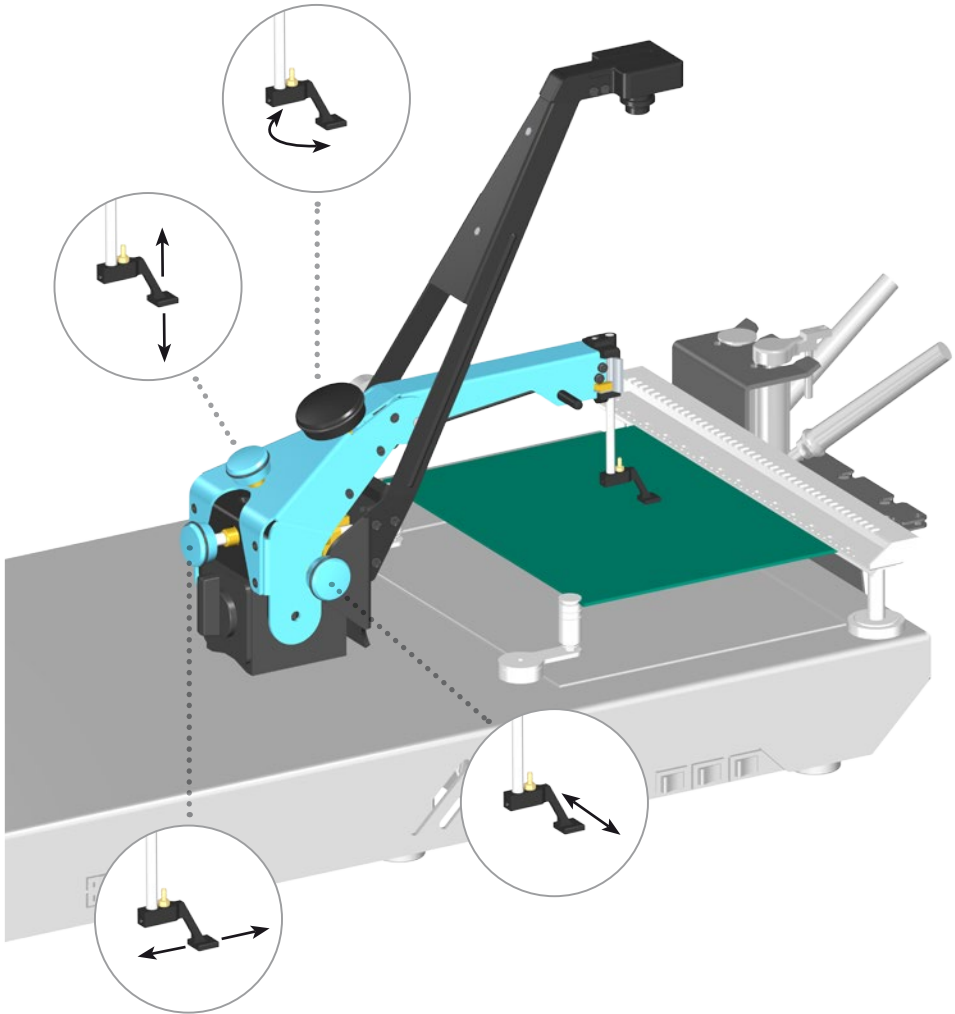

15

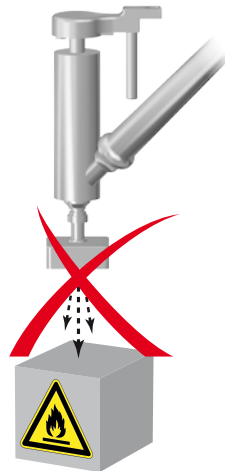
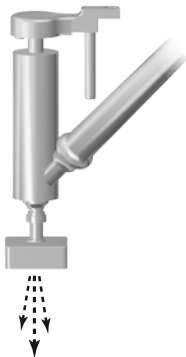
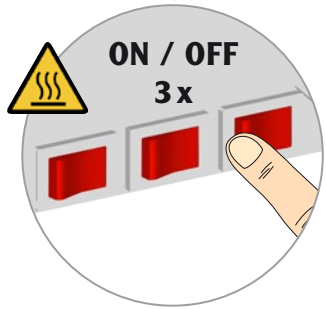
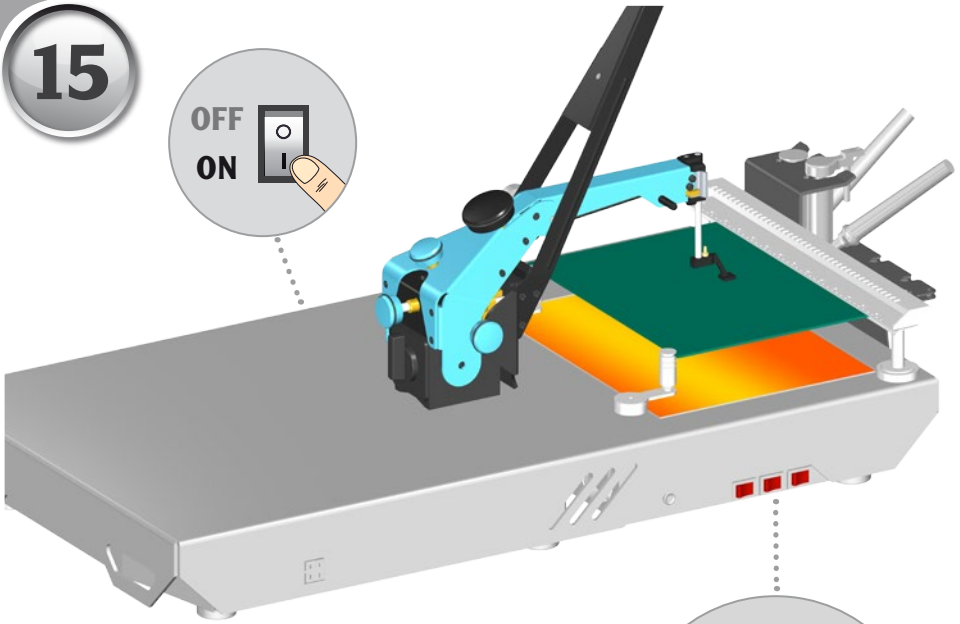
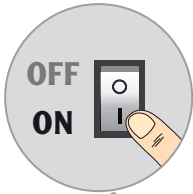

16

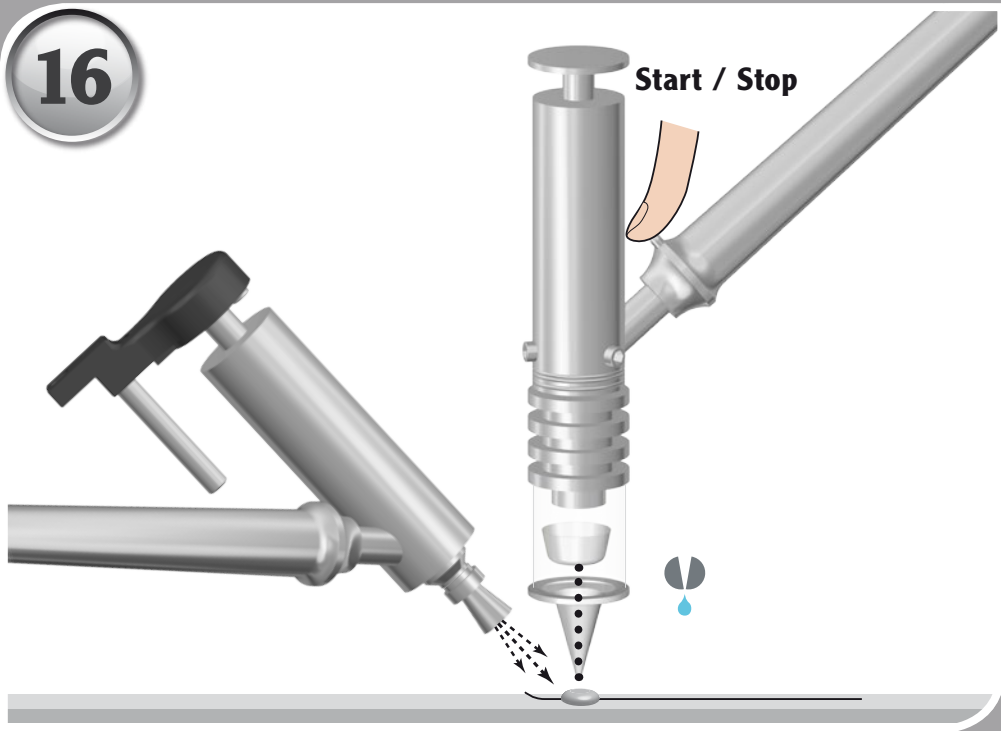

17

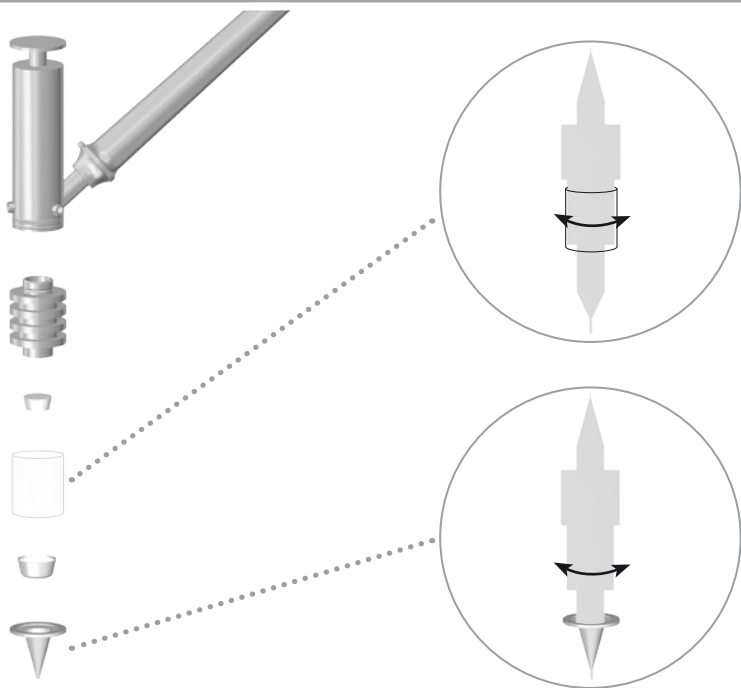



Read these instructions and the safety guidelines carefully before starting up the unit and starting work.

Installation and commissioning of the machines which we have supplied may only be performed by authorized specialist personnel.

Failure to observe the safety regulations results in a risk to life and limb.

Keep these instructions in a place that is accessible to all users.

Safety information

For safety reasons, children and youths under the age of 16, as well as persons who are not familiar with these operating instructions, may not use the device. Children shall not play with the appliance.

This device is not intended for use by persons (including children) with limited physical, sensory or mental aptitude, or by persons who lack knowledge or experience in handling the device.

Keep other persons well away from your workplace.

The work area is out of bounds for children and unauthorised persons. Never allow other persons to touch the soldering tool or cable.

WARNING Danger of injury

The device or parts of the device may fall off during transportation.



The wearing of metal objects and wristwatches is prohibited.



Persons with cardiac pacemakers or other medical implants may not use these drill stands.



The carrying of magnetic or electronic data storage devices is prohibited.

WARNING Danger of crushing injuries!

Magnetic printed circuit board holders can attract each other and lock together.

- Store magnetic components separately from each other.
- Always leave printed circuit board terminals on the work surface.
- Do not place printed circuit board terminals too close to each other.



WARNING Electrical shock

Connecting the control unit incorrectly poses a risk of injury due to electric shock and can damage the device.

- Carefully read the attached safety information, the safety information accompanying these operating instructions as well as the operating instructions for your control unit before putting the control unit into operation and observe the safety precautions specified therein.
- Only connect WELLER tools.

If the device is faulty, active electrical conductors may be bare or the PE conductor may not be functional.

- Repairs must always be referred to a Weller-trained specialist.
- 'If the electrical tool's power supply cord is damaged, this must be replaced with a specially prefabricated power supply cord available through the customer service organisation.'

Protect yourself against electric shocks. The handles on soldering tools with an antistatic design are conductive.

- Avoid touching earthed objects such as pipes, heaters, cookers and refrigerators..
- Do not use the soldering tool in a damp or wet environment.
- Never work on voltage-carrying parts.



WARNING Fire hazard

Covering the soldering iron or the safety holder poses a fire hazard. Always keep objects well away from the soldering iron and safety holder.

- Always keep objects well away from the soldering iron and safety holder.
- Keep all combustible objects, liquids or gases well away from the hot soldering tool.
- Do not place flammable materials close to the bottom heater or to the hot air pen.
- The bottom heater and the hot air pen should only be operated on a non-flammable, level work surface.
- Once switched on, never leave the tool unattended.
- Do not squeeze or crush the tubing of the hot air pen. Disruption of the air flow can cause the heating cartridge to overheat.



WARNING
IR and visible radiation emitted from the bottom heater is a potential eye hazard.

- The preheating plate may only be operated in conjunction with a printed circuit board.

▲ WARNING Risk of burns

High temperatures occur during operation of the hot air pen.

- Do not touch the cartridge of the hot air pen, the nozzles and the glass of the bottom heater.
- Do not direct hot air at body parts.
- Do not direct hot air soldering tools at people or inflammable objects.
- Only replace nozzles when cold
- Always place the soldering tool in the safety rest while not in use. Make sure the safety holder is stable.

When the bottom heater is in operation, high temperatures occur at the housing, cooling air outlet and irradiated surfaces. Tools may still be hot long after they have been switched off.

- Do not touch the hot tools and workpieces.
- Do not touch the housing until it has cooled down.
- Soldering profiles must be configured so that the printed circuit boards are cold on removal.
- Wear gloves when removing the printed circuit boards. Care must be taken to ensure that hot printed circuit boards are beyond the reach of third parties after removal.

Risk of burning through liquid solder. Protect yourself against solder splashes.

- Wear appropriate protective clothing to protect yourself against burns. Protect your eyes by wearing eye protectors.
- When working with adhesives, special attention must be paid to the warning information provided by the adhesive manufacturer.
- Avoid skin contact with the adhesive or the solder paste. Skin contact with these substances can have adverse health effects.

▲ WARNING Danger of poisoning

The soldering process can produce hazardous solder vapours. Hazardous vapours and other aerosols may be released when printed circuit boards are heated and/or overheated.

- Use a solder fume extraction unit.

Store your soldering tool in a safe place. When not in use, units and tools should be stored in a dry, high or locked area out of the reach of children.. Make sure that unused soldering tools are free of voltage and de-pressurised.

The mains cable must only be plugged into the mains socket or adapter approved for this purpose. Check to see if the mains voltage matches the ratings on the nameplate. Make sure the machine is switched off before plugging in.

Do not use the cable for purposes other than those for which it is intended. Never carry the unit by the cable. Do not use the cable to pull the plug out of the socket. Protect

the cable against heat, oil and sharp edges..

Be alert. Pay attention to what you are doing. Be smart when using the unit. Do not use the soldering tool if you are having difficulty concentrating.

Avoid abnormal posture. Arrange your work station in an ergonomically correct way. Avoid bad posture when using the unit, as this can lead to postural problems.

The soldering tool must be operated only in perfect technical working order. Safety devices must not be deactivated.

Faults and defects must be repaired immediately.

Before using the unit / tool, safety devices must be carefully checked to make sure that they are functioning properly and in the manner intended. Check that moving parts are functioning properly and are not sticking, and whether parts are damaged. All parts must be correctly fitted and must satisfy all the requirements necessary to guarantee troublefree operation of the unit.

Use the correct tool. Use only accessories or auxiliary devices which are included in the list of accessories or approved for use by the manufacturer. Use WELLER accessories or auxiliary devices on original WELLER equipment only. The use of other tools and other accessories can cause injury.

Secure the tool. Use clamping fixtures to hold the workpiece.

Specified Conditions Of Use

The BGA/QFP repair system may only be used for the repair of SMD components on electronic assemblies, as well as for the removal of old solder and soldering work with hot air and infra-red heat.

This device may only be used at room temperature and indoors. Protect against moisture and direct sunlight.

User groups

Due to differing degrees of risk and potential hazards, several work steps may only be performed by trained experts.

Work step	User groups
Installation., Starting up the device	Specialist personnel with technical training
Replacing electrical replacement parts	Electricians
Default maintenance intervals	Safety expert
Operation	Non-specialists (semi-skilled, experienced)
Operation Replacing electrical replacement parts	Technical trainees under the guidance and supervision of a trained expert

Care and maintenance



Before doing any work on the machine, pull the plug out of the socket. Leave the unit to cool down.

Check all connected cables and hoses on a regular basis. If power tools are damaged, they must be immediately removed from use. Do not use blocked nozzles.

Repairs must always be referred to a Weller-trained specialist.



Use original replacement parts only.

Warranty

Claims by the buyer for physical defects are time-barred after a period of one year from delivery to the buyer. This does not apply to claims by the buyer for indemnification in accordance with §§ 478, 479 BGB (German Federal Law Gazette).

We shall only be liable for claims arising from a warranty furnished by us if the quality or durability warranty has been furnished by use in writing and using the term „Warranty“.

The warranty shall be void if damage is due to improper use and if the device has been tampered with by unauthorised persons.

For more information please visit www.weller-tools.com.

Technical Data

Repair station		WTQB 1000
Dimensions L x W x H	(mm)	660 x 360 x 390
	(inch)	25,98 x 14,17 x 15,35
Weight	(kg)	22
Mains supply voltage	(V / Hz)	230 / 50
Power consumption	(W)	2300
Safety class		I
Air flow	l/min	6 - 35
Temperature range Top Heater	°C	150 – 400°
	°F	
Top heater	(W)	300
Bottom heater	(W)	max. 2000
Operating sound level from 1 m distance	(dB (A))	62
Compressed air connection oil-free, dry compressed air	bar	5,5 - 8

Symbols



Caution!



Warning! Risk of burns!



Read the operating instructions!



Before performing work of any kind on the unit, always disconnect the power plug from the socket.



ESD-compatible design and ESD-compatible workstation



CE mark of conformity



Disposal

Do not dispose of electric tools together with household waste material! In observance of European Directive 2012/19/EU on waste electrical and electronic equipment and its implementation in accordance with national law, electric tools that have reached the end of their life must be collected separately and returned to an environmentally compatible recycling facility.

Original declaration of conformity

Repair station WTQB 1000

We hereby declare that the products described herein comply with the following guidelines:

2006/42/EG, 2014/30/EU, 2011/65/EU

Applied harmonised standards:

DIN EN 60204-1: 2007-06
 DIN EN 60335-1: 2012-10
 DIN EN 60335-2-45: 2012-08
 DIN EN 62233: 2008-11/2009-04
 DIN EN 55014-1: 2012-05
 DIN EN 55014-2: 2009-06
 DIN EN 50581:2013-02



Besigheim, 2016-03-08

T. Fischer
 Technical director

B. Fröhwald
 Managing director

Authorised to compile technical documentation.

Weller Tools GmbH
 Carl-Benz-Straße 2, 74354 Besigheim, Germany



试运行前和使用该装置前，请通读本说明书及安全注意事项。

仅允许由授权专业人员安装和调试我们提供的机床。

如不遵守这些安全规定，则有受伤和致命危险。

将说明放在用户可获取的位置。

安全信息

出于安全原因，16岁以下的儿童和青少年以及不了解本操作说明的人员禁止使用本装置。儿童不得玩弄设备。

本装置不适合由身体、感官或精神上有障碍或缺乏经验和/或缺乏知识的人员（包括儿童）使用。

请让其他人员远离您的工位。

儿童和未经许可的人员不得逗留在工作区域内。请勿让其他人员触摸焊接工具或电缆。

警告 小心受伤。

运输途中设备或设备部件可能掉落。



禁止携带金属部件和钟表。



装有心脏起搏器或其他医疗植入物的人员不得使用该钻台。



禁止携带磁性或电子数据载体。

警告 挤伤风险

磁性线路板支架可能会拉紧并互相卡住。

磁性部件应分开保存。

线路板接线端子始终留在工作面上。

线路板接线端子靠的不可太近。

警告 触电

控制单元连接不当存在电击伤害危险且可能损坏本装置。

运行控制部件前，请仔细阅读随附的安全信息、操作说明中的安全信息和控制部件操作说明，并遵守操作说明中规定的安全注意事项。

仅连接WELLER工具。

如设备产生损坏，可能会有带电接触点暴露或PE保护插头不起作用。

维修应由Weller培训的专业人员进行。

如电动工具的电源线损坏，须通过客服组织替换专用的电源线。

请采取相应措施，以防触电。在采用抗静电设计的焊接工具上，手柄具有导电能力。

请避免与接地部件有身体接触，例如管道、加热体、炉灶和冰箱。

请勿在潮湿的环境下使用焊接工具。

请勿在带电部件上作业。

警告 火灾风险

用物体覆盖焊接装置或安全置放架有火灾危险。

始终确保能接触到焊接装置和安全置放架。

请勿将易燃物体、液体或气体置于炽热的焊接工具附近。

不要将可燃材料放在底部加热装置或热风笔附近。

仅在不可燃的平坦工作面上使用底部加热装置和热风笔。

不要让已启动的设备在无人看管的情况下工作。

不要挤压热风笔的软管。气流中断可能会导致电热芯过热。

警告

底部加热装置发出的红外可见辐射对眼部有害。

预热板只能带着印刷电路板工作。

警告 小心烫伤**使用热风笔时会产生高温。**

不要触摸热风笔的笔芯、喷嘴和底部加热装置的玻璃。

避免热风吹到身体部位。

请勿将热风焊铁对准人员或易燃物体。

仅在冷态下更换喷嘴

焊接工具不用时，请放在安全支架上。请确保安全置放架的状态可靠。

使用底部加热装置时，壳体、冷却空气出口和被辐射区域会产生高温。工具断电后很长时间温度仍保持较高。

不要触摸炽热的工具和工件。

冷却后才可触摸壳体。

配置焊料时应确保能够取下冷却的电路板。

戴手套取下印刷电路板。注意：取走后放下炽热的印刷电路板时确保没有其他人能接触到。

熔化的焊锡存在烫伤危险。防止被锡液溅到。

请穿上防护服，以防烫伤。戴上眼罩，保护眼睛。

处理粘剂时，尤其要注意粘剂制造商的警告。

绝对避免皮肤接触粘剂或焊膏。皮肤与这些物质接触会损坏健康。

警告 中毒危险**焊接过程中产生的烟雾有害。印刷电路板加热和过热时产生的烟雾及其他悬浮颗粒有害。**

请使用焊接排烟装置。

请妥善保管您的焊接工具。 应将不用的装置和工具存放在干燥、较高或锁起来的地方，确保儿童不会接触到。将不使用的焊接工具切换成无电压和无压力状态。

只允许将电源线插在允许为此使用的电源插座或适配器上。 查看电源电压是否符合铭牌上的额定值。仅在关闭状态下将装置连接到插座上。

请勿将电缆用于不符合规定的用途。 切勿抓住电缆提拎本装置。请勿使用电缆将插头从插座中拉出。保护电缆远离热源、油和锋利边缘。

请小心操作。 请留意正在进行的操作。请理智地工作。当您注意力不集中时，请勿使用本焊接工具。

避免不正常的身体姿势。 请按照人体工程学设计正确布置您的工位。工作时避免错误姿势，否则会引起肌体损伤。

仅允许在无技术故障的状态下运行焊接工具。 禁止停用保护装置。

必须立即排除故障和损坏。 每次使用本装置/工具前，必须仔细检查保护装置的功能是否正常且合乎规定。检查活动部件是否正常工作且没有卡住或部件是否损坏。所有部件必须正确安装且满足各项条件，以确保正常运行本装置。

请使用正确的工具。 请只使用附件列表中或由制造商许可的附件或附加装置。WELLER附件或附加装置请只用在原装WELLER装置上。使用其他工具和其他附件可能带来受伤危险。

请固定住工具。 请使用夹紧装置夹紧工具。

规定的使用条件

BGA/QFP返修系统仅允许用于修理电子总成上的SMD部件以及用热风和红外加热器清除旧焊料和进行焊接工作。该设备仅允许室温条件下在室内使用。避免潮湿和阳光直射。

用户群体

由于危险和潜在危险程度的不同，几个工作步骤仅可由受过培训的专业人士进行操作。

工作步骤	用户群体
安装, 调试	具有技术培训的专业人员
更换电气备件	电工/电气技师
默认维护周期	安全专家
操作	非专门人员 (学习, 了解)
操作 更换电气备件	训练有素的专家指导和监督下的技术培训生

小心维护**警告**

对机器进行任何操作前，请将插头拔出插座。让设备冷却。

请定期检查所有连接的电缆和软管。将受损的电动工具立即从所有应用环境中取走。不允许使用堵塞喷嘴。

维修应由Weller培训的专业人员进行。

仅使用原装替换件。

**保修**

向买方交付设备一年后，买方无权就设备物理缺陷提出索赔。这条规定不适用买方根据§§ 478, 479 BGB（德国联邦法律公报）提出的索赔。

除非使用前，我方使用术语“保修”书面提供质量或耐用性保修，否则我方不对因我方提供的保修引起的索赔承担责任。

如因不当使用或未经授权的人士篡改设备导致设备损坏，保修无效。

更多信息请访问
www.weller-tools.com.

技术资料

返修台		WTQB 1000
尺寸, 长 x 宽 x 高	(mm) (inch)	660 x 360 x 390 25,98 x 14,17 x 15,35
重量	(kg)	22
电源电压	(V / Hz)	230 / 50
电源	(W)	2300
安全等级		I
风量	l/min	6 - 35
温度范围 Top Heater	° C ° F	150 - 400°
顶部加热	(W)	300
底部加热	(W)	max. 2000
1米距离的噪声级	(dB (A))	62
压缩空气接头 用于无油、干燥的压缩 空气	bar	5,5 - 8

符号/标志



小心!



警告! 小心烫伤!



阅读操作说明



在装置上进行任何操作前, 从插座拔出电源插头。



ESD-兼容设计和ESD兼容工作站



CE不合格标志



处理

请勿同生活垃圾一起处理电动工具! 按照国家法律和关于废旧电子电气设备的欧盟指令2012/19/EU规定, 单独收集寿命终止的电动工具, 并将其返回至环保回收工厂。

符合标准说明原件

返修台 WTQB 1000

我方特此声明: 所述产品符合以下规范:
2006/42/EG, 2014/30/EU, 2011/65/EU

适用的统一标准:

DIN EN 60204-1: 2007-06
DIN EN 60335-1: 2012-10
DIN EN 60335-2-45: 2012-08
DIN EN 62233: 2008-11/2009-04
DIN EN 55014-1: 2012-05
DIN EN 55014-2: 2009-06
DIN EN 50581:2013-02



Besigheim, 2016-03-08

T. Fischer
技术总监B. Frühwald
总经理

经授权编制技术文件

Weller Tools GmbH

Carl-Benz-Strasse 2, 74354 Besigheim, Germany

北京海洋兴业科技股份有限公司

北京市西三旗东黄平路 19 号龙旗广场 4 号楼(E座)906 室

电 话: 010-62176775 62178811 62176785

企业 QQ: 800057747

企业官网: www.hyxyyq.com

邮编: 100096

传真: 010-62176619

邮箱: info.oi@oitek.com.cn购线网: www.gooxian.net

扫描二维码关注我们
查找微信企业号: 海洋仪器